

DreamJet Slide Shower Chrome & Black **VDRM043**



Congratulations on your purchase of this high quality product from Voda Plumbingware. Please read the following before installation and retain (along with your receipt).

TECHNICAL SPECIFICATIONS

Suitable for All Pressures

Minimum Pressure = 50kPa

Maximum operating Pressure = 500kPa

Maximum operating Temperature = 65 deg. Celsius

For domestic use only.

CONFIGURATION

Mains Pressure systems Install as supplied.

Unequal Low systems First remove the flow restrictor disc from inside the screw end of the handpiece.

Equal Low systems First remove the flow restrictor disc from inside the screw end of the handpiece.

CONTENTS

- Rail with adjuster/holder
- Wall brackets and covers
- Fixing kit
- 1.5m supply hose
- Supply elbow
- Shower handpiece
- Flow restrictor for Mains Pressure installation

INSTALLATION

See steps on the next page, then attach the supply elbow to the supply connection on the wall.

If installing on Low or Unequal water pressure systems - please remove the flow restrictor disc for optimal flow.

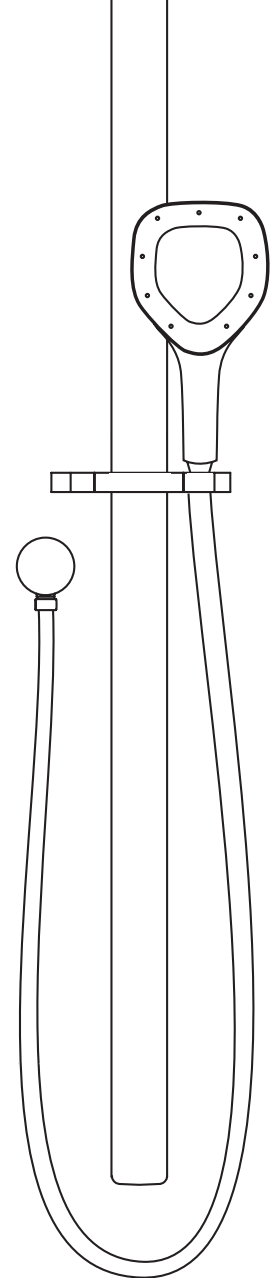

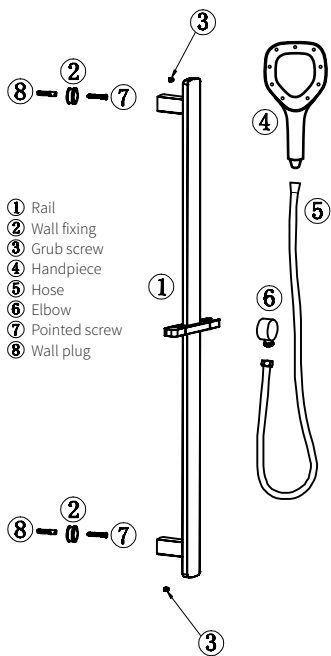

- ① Rail
- ② Wall fixing
- ③ Grub screw
- ④ Handpiece
- ⑤ Hose
- ⑥ Elbow
- ⑦ Pointed screw
- ⑧ Wall plug

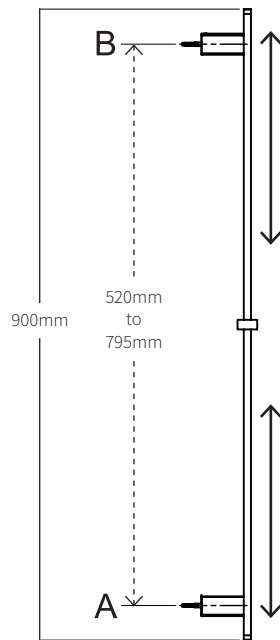

Wall brackets can be adjusted to achieve desired height.

ATTACH PROOF OF PURCHASE HERE

1. Measure and mark hole positions (at points A and B) with a pencil at the required distance (max. 795mm apart).
2. Drill two mounting holes where you have marked.
3. Fit the wall fixing parts into the drilled holes.
4. Push the rail bracket onto the wall fixings, then tighten the grub screws.
5. Fix the elbow to the wall.
6. Attach hose to elbow and handpiece then insert shower handpiece into holder.

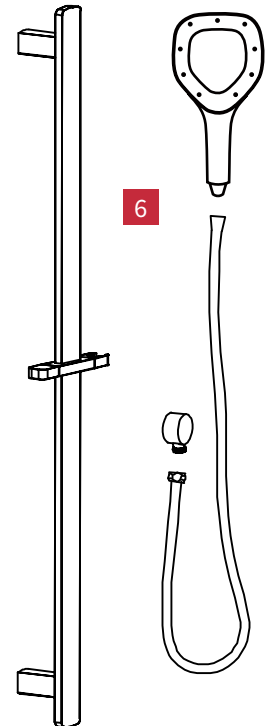
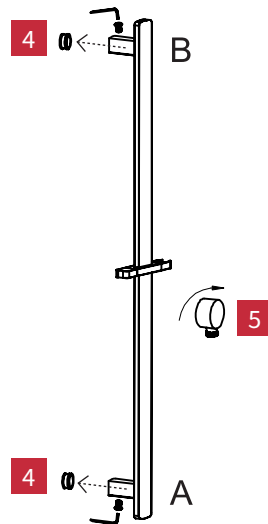
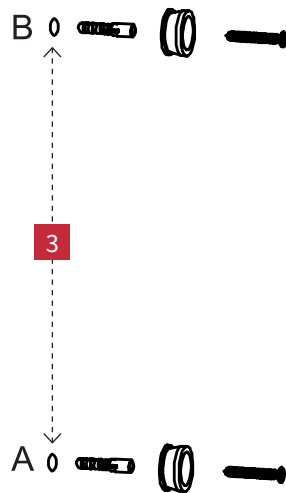
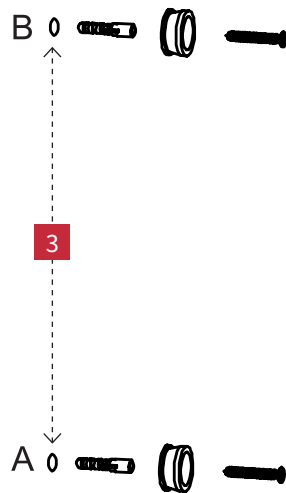
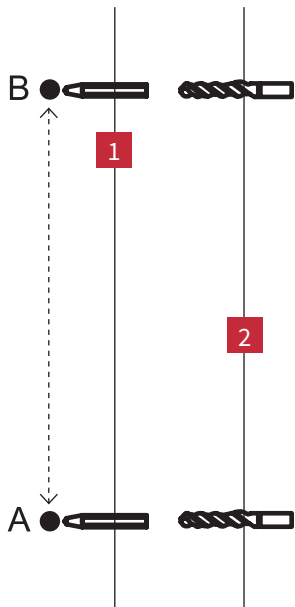

WARRANTY

Please refer to our website for warranty information: www.vodaplumbingware.co.nz/warranty

In the unlikely event that this product fails during its warranty period, phone our Customer Service team immediately on 0508 367 366 – as unauthorised removal of the product may void the warranty.

CARE AND MAINTENANCE

Chrome-plated finishes should not be cleaned with astringent, abrasive or citric cleaners.

A soft, damp cloth is recommended for cleaning. Mild soap solutions can also be used on occasion.