

Pro Series Brass Shower Rose **VPRS080**

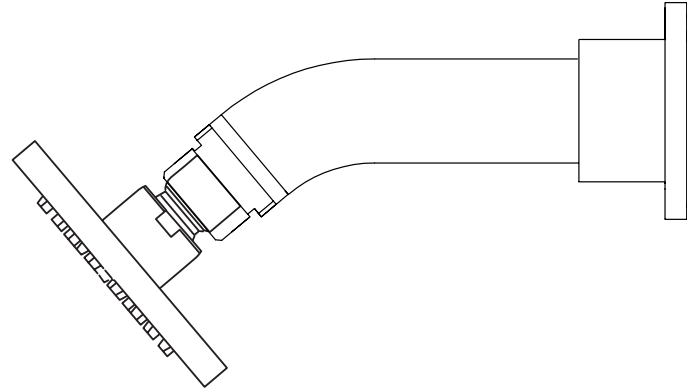

Congratulations on your purchase of this high quality product from Voda Plumbingware.
Please read the following before installation and retain (along with your receipt) for future reference.

TECHNICAL SPECIFICATIONS

Suitable for All Pressures

Minimum Pressure = 35kPa

Maximum operating Pressure = 500kPa

Maximum operating Temperature = 65 deg. Celsius

For domestic use only.

CONFIGURATION

Mains Pressure systems Install the flow restrictor as shown in the restrictor pack.

Unequal Low systems Install as supplied.

Equal Low systems Install as supplied.

INSTALLATION

- Prior to installation, ensure mains water is turned off.
- Screw the shower arm to the wall connection and tighten. NB: Use a liberal amount of teflon thread tape or hemp & grease at wall connection.
- Turn on mains.
- Check for leaks.

ATTACH PROOF OF PURCHASE HERE

WARRANTY

Please refer to our website for warranty information: **www.vodaplumbingware.co.nz/warranty**

In the unlikely event that this product fails during its warranty period, phone our Customer Service team immediately on 0508 367 366 – as unauthorised removal of the product may void the warranty.

CARE AND MAINTENANCE

Chrome-plated finishes should not be cleaned with astringent, abrasive or citric cleaners.

A soft, damp cloth is recommended for cleaning. Mild soap solutions can also be used on occasion.